



Warren Close Widdrington

- Detached Family Home
- Enclosed Rear Garden
- Three Bedroomed
- Garage and Driveway
- Modern Decor
- Freehold

Offers In Excess Of: £185,000

01670 511711
17 Newgate Street, Morpeth

ROOK
MATTHEWS
SAYER

www.rookmatthewssayer.co.uk
morpeth@rmsestateagents.co.uk

Warren Close, Widdrington

Guaranteed to impress, sits this beautifully presented three bed detached home on Warren Close, Widdrington. Situated in a quiet cul de sac location this brand-new development has been incredibly popular with house hunters. Widdrington is a small and quiet village with local amenities on your doorstep to include a local Co-op, and doctor's surgery. Excellent for those who need to commute with the A1 just under three miles away plus around a fifteen-minute drive away you have easy access into the hustle and bustle of Morpeth town centre.

The property briefly comprises: - Entrance hallway which leads you straight into a bright and airy lounge due to the double aspect windows and finished with light beige carpets with modern decor. The kitchen/diner offers great space with double patio doors which leads you straight into the rear garden. The high spec kitchen has been fitted with a range of wall and base units, offering an abundance of storage. Appliances include fridge/freezer, electric oven and hob, dishwasher and washing machine. You further benefit from a downstairs W.C.

To the upper floor of the accommodation, you have three good sized rooms, two doubles and one single all of which have been carpeted throughout and finished with crisp white walls. The master bed further benefits from its own en-suite shower room. The family bathroom has been fitted with W.C, hand basin and bath tub.

Externally, the property has a private driveway which can accommodate at least two cars, and a single garage, whilst to the rear you have a fully enclosed garden which has been laid to lawn with patio area, making it ideal for those who enjoy out door entertaining

We anticipate interest to be high, call now to arrange your viewing.

- Lounge: 14'6 x 11'2 (4.42m x 3.40m)
- Kitchen: 14'6 x 9'6 (4.42m x 2.90m)
- W.C: 5'5 x 2'10 (1.65m x 0.64m)
- Bedroom One: 14'5 x 8'0 Biggest Points (4.39m x 2.44m Biggest Points)
- En-Suite: 6'4 x 5'6 (1.93m x 1.68m)
- Bedroom Two: 9'6 x 8'1 (2.90m x 2.46m)
- Bedroom Three: 8'6 x 6'1 (2.59m x 1.85m)
- Bathroom: 6'1 x 6'1 (1.85m x 1.85m)

PRIMARY SERVICES SUPPLY

- Electricity: Mains
- Water: Mains
- Sewerage: Mains
- Heating: Gas Central Heating
- Broadband: Fibre to Premises
- Mobile Signal / Coverage Blackspot: No
- Parking: Driveway and Garage

TENURE

Freehold – It is understood that this property is freehold, but should you decide to proceed with the purchase of this property, the Tenure must be verified by your Legal Adviser

- EPC Rating: B
- Council Tax Band: C

M00008144.AB.JD.18/10/24.V.3

| Score | Energy rating | Current | Potenti |
|-------|---------------|---------|---------|
| 92+ | A | | 95 A |
| 81-91 | B | 83 B | |
| 69-80 | C | | |
| 55-68 | D | | |
| 39-54 | E | | |
| 21-38 | F | | |
| 1-20 | G | | |

Important Note: Rook Matthews Sayer (RMS) for themselves and for the vendors or lessors of this property, whose agents they are, give notice that these particulars are produced in good faith, are set out as a general guide only and do not constitute part or all of an offer or contract. The measurements indicated are supplied for guidance only and as such must be considered incorrect. Potential buyers are advised to recheck the measurements before committing to any expense. RMS has not tested any apparatus, equipment, fixtures, fittings or services and it is the buyer's interests to check the working condition of any appliances. RMS has not sought to verify the legal title of the property and the buyers must obtain verification from their solicitor. No persons in the employment of RMS has any authority to make or give any representation or warranty whatever in relation to this property.

Money Laundering Regulations – intending purchasers will be asked to produce original identification documentation at a later stage and we would ask for your co-operation in order that there will be no delay in agreeing the sale. We will also use some of your personal data to carry out electronic identity verification. This is not a credit check and will not affect your credit score.

16 Branches across the North-East



Warren Close, Widdrington

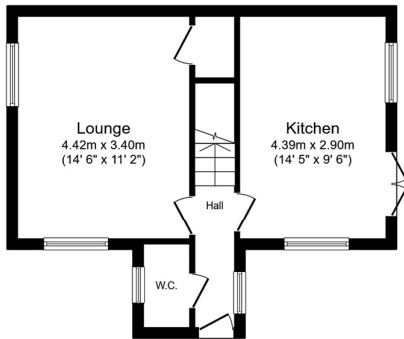

Ground Floor

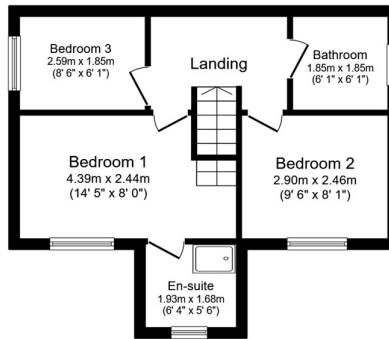

First Floor

This floor plan is for illustrative purposes only. It is not drawn to scale. Any measurements, floor areas (including any total floor area), openings and orientations are approximate. No details are guaranteed, they cannot be relied upon for any purpose and do not form any part of any agreement. No liability is taken for any error, omission or misstatement. A party must rely upon its own inspection(s). Powered by www.Propertybox.io



Important Note: Rook Matthews Sayer (RMS) for themselves and for the vendors or lessors of this property, whose agents they are, give notice that these particulars are produced in good faith, are set out as a general guide only and do not constitute part or all of an offer or contract. The measurements indicated are supplied for guidance only and as such must be considered incorrect. Potential buyers are advised to recheck the measurements before committing to any expense. RMS has not tested any apparatus, equipment, fixtures, fittings or services and it is the buyer's interests to check the working condition of any appliances. RMS has not sought to verify the legal title of the property and the buyers must obtain verification from their solicitor. No persons in the employment of RMS has any authority to make or give any representation or warranty whatever in relation to this property.

Money Laundering Regulations – intending purchasers will be asked to produce original identification documentation at a later stage and we would ask for your co-operation in order that there will be no delay in agreeing the sale. We will also use some of your personal data to carry out electronic identity verification. This is not a credit check and will not affect your credit score.

16 Branches across the North-East

