



Cheviot Grove

Pegswood

- Detached Bungalow
- Three Bedrooms
- Enclosed Rear Garden
- No Onward Chain
- Garage Plus Driveway
- Freehold

Offers In Excess Of £230,000

01670 511 711
morpeth@rmsestateagents.co.uk

ROOK
MATTHEWS
SAYER

www.rookmatthewssayer.co.uk
morpeth@rmsestateagents.co.uk

Cheviot Grove

Pegswood

Tucked away within a quiet cul-de-sac location, sits this beautifully presented three bedroomed detached bungalow Cheviot View, Pegswood. These bungalows are always in high demand, due to the extensive internal floor space, offering bright and spacious rooms with a stunning enclosed garden to the rear. Pegswood itself offers great local amenities on your doorstep to include a Co-op and doctor's surgery, whilst the historic town centre of Morpeth is a short drive away, where you can enjoy all the hustle and bustle this busy market town has to offer with an array of bars, restaurants, river walks and shopping delights.

The property briefly comprises:- Entrance hallway which leads seamlessly into a large bright and airy open plan lounge/kitchen, which allows floods of natural light with stunning views over the rear garden from the patio doors. The modern kitchen has been fitted with a range of wall and base units, offering an abundance of storage and makes full use of those picture-perfect garden views. Appliances include electric oven/hob and extractor fan. You further benefit from a separate utility area which provides access directly into the garage.

You have three good sized bedrooms, two doubles and one single, which could also be used as an office to suit your needs. All bedrooms have been fitted with carpets and finished with modern décor, whilst their main bedroom offers fitted wardrobes, offering excellent storage. The family shower room has been finished to a great standard, completed with a crisp white tile and fitted with, W.C., hand basin and large walk-in shower.

Externally you have a private driveway to accommodate at least two cars plus a garage. Additional parking is available on street. To the rear you have a fabulous enclosed garden which is currently laid to lawn with a separate decked patio area, where you can relax on a morning. The garden will be a real winner with those who enjoy the outdoor living.

With no onward chain, we anticipate a vast amount of interest. Please call us now to arrange your viewing.

| | |
|----------------------------------|----------------------------|
| Lounge: 27'11 x 18'10 Max Points | (8.51m x 5.74m Max Points) |
| Kitchen: 20'11 x 8'0 Max Points | (6.38m x 2.44m Max Points) |
| Utility: 5'4 x 5'0 | (1.62m x 1.52m) |
| Bedroom One: 10'5 x 10'4 | (3.18m x 3.15m) |
| Bedroom Two: 11'6 x 11'2 | (3.51m x 3.40m) |
| Bedroom Three: 8'1 x 7'9 | (2.46m x 2.36m) |
| Bathroom: 7'2 x 5'5 | (2.18m x 1.65m) |

PRIMARY SERVICES SUPPLY

Electricity: Mains

Water: Mains

Sewerage: Mains

Heating: Mains Gas

Broadband: None

Mobile Signal / Coverage Blackspot: No

Parking: Private driveway plus Garage

TENURE

Freehold – It is understood that this property is freehold, but should you decide to proceed with the purchase of this property, the Tenure must be verified by your Legal Adviser

EPC Rating: TBC

Council Tax Band: C

M00008330.AB.JD.11/02/2025.V.1

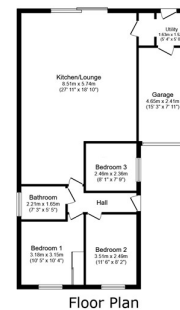

This floor plan is for illustrative purposes only. It is not drawn to scale. All measurements from area including any built floor areas, openings and construction are approximate. We advise our customers that cannot be relied upon for any purpose and to seek their own professional advice. We hold no liability for any error or omission or misstatement. A scale bar will also appear in some representations. Powered by www.floorplans.co.uk

Important Note: Rook Matthews Sayer (RMS) for themselves and for the vendors or lessors of this property, whose agents they are, give notice that these particulars are produced in good faith, are set out as a general guide only and do not constitute part or all of an offer or contract. The measurements indicated are supplied for guidance only and as such must be considered incorrect. Potential buyers are advised to recheck the measurements before committing to any expense. RMS has not tested any apparatus, equipment, fixtures, fittings or services and it is the buyer's interests to check the working condition of any appliances. RMS has not sought to verify the legal title of the property and the buyers must obtain verification from their solicitor. No persons in the employment of RMS has any authority to make or give any representation or warranty whatever in relation to this property.

Money Laundering Regulations – intending purchasers will be asked to produce original identification documentation at a later stage and we would ask for your co-operation in order that there will be no delay in agreeing the sale. We will also use some of your personal data to carry out electronic identity verification. This is not a credit check and will not affect your credit score.

16 Branches across the North-East

